

## The Swan Lake 6751: Details

**AS LOW AS \$250**  
**FULLY CUSTOMIZABLE &**  
**PROFESSIONALLY DESIGNED**

<b>Style</b>	Country French
<b>Exterior Materials</b>	Stucco & Cultured Stone
<b>Bedrooms</b>	5
<b>Bathrooms</b>	5 / 1
<b>Total Living Sq Ft</b>	6,751
<b>Total Covered Sq Ft</b>	8,361
<b>Dimensions (w x d x h)</b>	125'1" x 84'11" x 35'0"

	First Floor	Other Floors	Other Features	
<b>Square Footage</b>	4,618	2,133	Bar	Interior Balcony
<b>Bedrooms</b>	1	4	Bonus Room	Master with Sitting Area
<b>Ceiling Heights</b>	10'0"	9'0"	Butler Pantry	Mud Entry
<b>Master Bedroom</b>	X		Cabana Bath	Outdoor Fireplace
<b>Dining Room</b>	X		Covered Front Porch	Outdoor Kitchen
<b>Living Room</b>	X		Covered Pavilion	Unfinished Storage
<b>Family Room</b>	X		Covered Rear Porch	
<b>Game Room</b>		X	Covered Side Porch	
<b>Study</b>	X		Foyer	
<b>Guest Room</b>	X		Gallery	
<b>Home Theater</b>		X	Home Office	

<b>Garage(s)</b>	Front Load Swing (Side Facing)
<b>Stairs</b>	Standard (2 flights)

## The Swan Lake 6751: Front Elevation



## The Swan Lake 6751: Floor 1

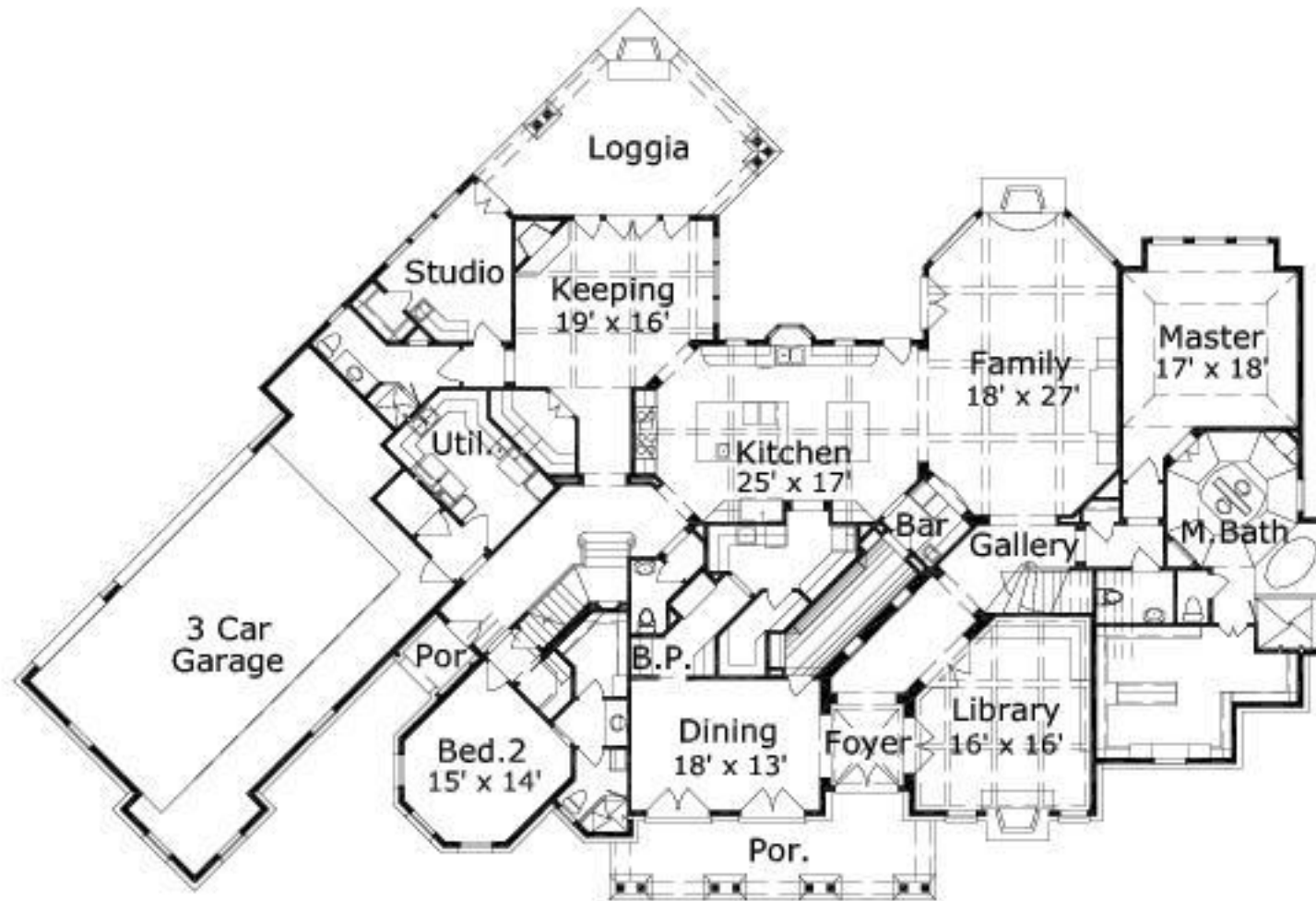

## The Swan Lake 6751: Floor 2

