

Lantana 6090: Details

AS LOW AS \$250
FULLY CUSTOMIZABLE &
PROFESSIONALLY DESIGNED

| | |
|-------------------------------|-------------------------|
| Style | Traditional |
| Exterior Materials | Stucco |
| Bedrooms | 4 |
| Bathrooms | 5 / 2 |
| Total Living Sq Ft | 6,090 |
| Total Covered Sq Ft | 8,673 |
| Dimensions (w x d x h) | 100'4" x 80'0" x 36'11" |

| | First Floor | Other Floors | Other Features |
|------------------------|-------------|--------------|--------------------|
| Square Footage | 4,093 | 1,997 | Bar |
| Bedrooms | 1 | 3 | Butler Pantry |
| Ceiling Heights | 10'0" | 9'0" | Cabana Bath |
| Master Bedroom | X | | Conservatory |
| Dining Room | X | | Covered Rear Porch |
| Living Room | X | | Exercise Room |
| Family Room | X | | Foyer |
| Game Room | | X | Interior Balcony |
| Study | X | | Outdoor Kitchen |
| Guest Room | | X | Playroom |
| | | | Unfinished Storage |

| | |
|------------------|------------------------|
| Garage(s) | Front Load Straight In |
| Stairs | Spiral (2 flights) |

Notes

The living area in this plan does not include the second story option quarters. The additional square footage for the second floor option quarters is 387 square feet.

Lantana 6090: Front Elevation



Lantana 6090: Floor 1

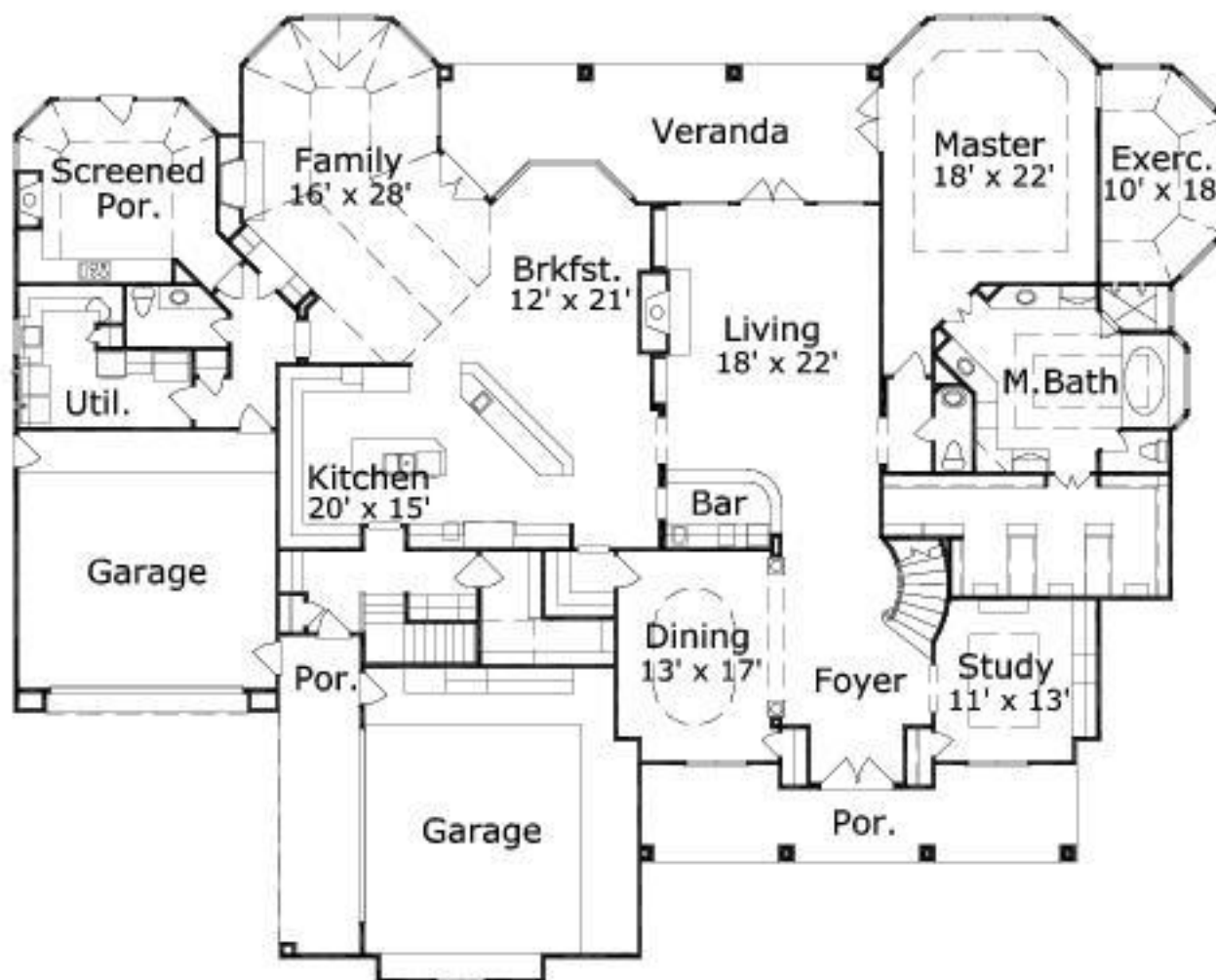

Lantana 6090: Floor 2

