

Leonardo 5690: Details

AS LOW AS \$250
FULLY CUSTOMIZABLE &
PROFESSIONALLY DESIGNED

Style	Country French
Exterior Materials	Stone & Stucco
Bedrooms	5
Bathrooms	5 / 3
Total Living Sq Ft	5,690
Total Covered Sq Ft	9,561
Dimensions (w x d x h)	120'9" x 128'0" x 40'3"

	First Floor	Other Floors	Other Features
Square Footage	3,968	1,722	Butler Pantry Separate Master Closet
Bedrooms	2	3	Cabana Bath Theater/Media
Ceiling Heights	10'0"	9'0"	Covered Front Porch Unfinished Storage
Master Bedroom	X		Covered Rear Porch
Dining Room	X		Foyer
Living Room	X		Gallery
Family Room	X		Home Office
Game Room		X	Interior Balcony
Study	X		Master Fireplace
Guest Room	X		Motor Court
Home Theater		X	Playroom
Garage(s)	Side Load Straight In		
Stairs	Spiral (2 flights)		

Notes

The living area of this plan does not include the bathroom off of the garage, the raised media room on the second floor and the bath off of the media room on the second floor. The additional square footage for the bath off of the garage is 74 square feet. The additional square footage for the raised media room and bath off of the media room, on the second floor, is 379 square feet.

Leonardo 5690: Front Elevation



Leonardo 5690: Floor 1

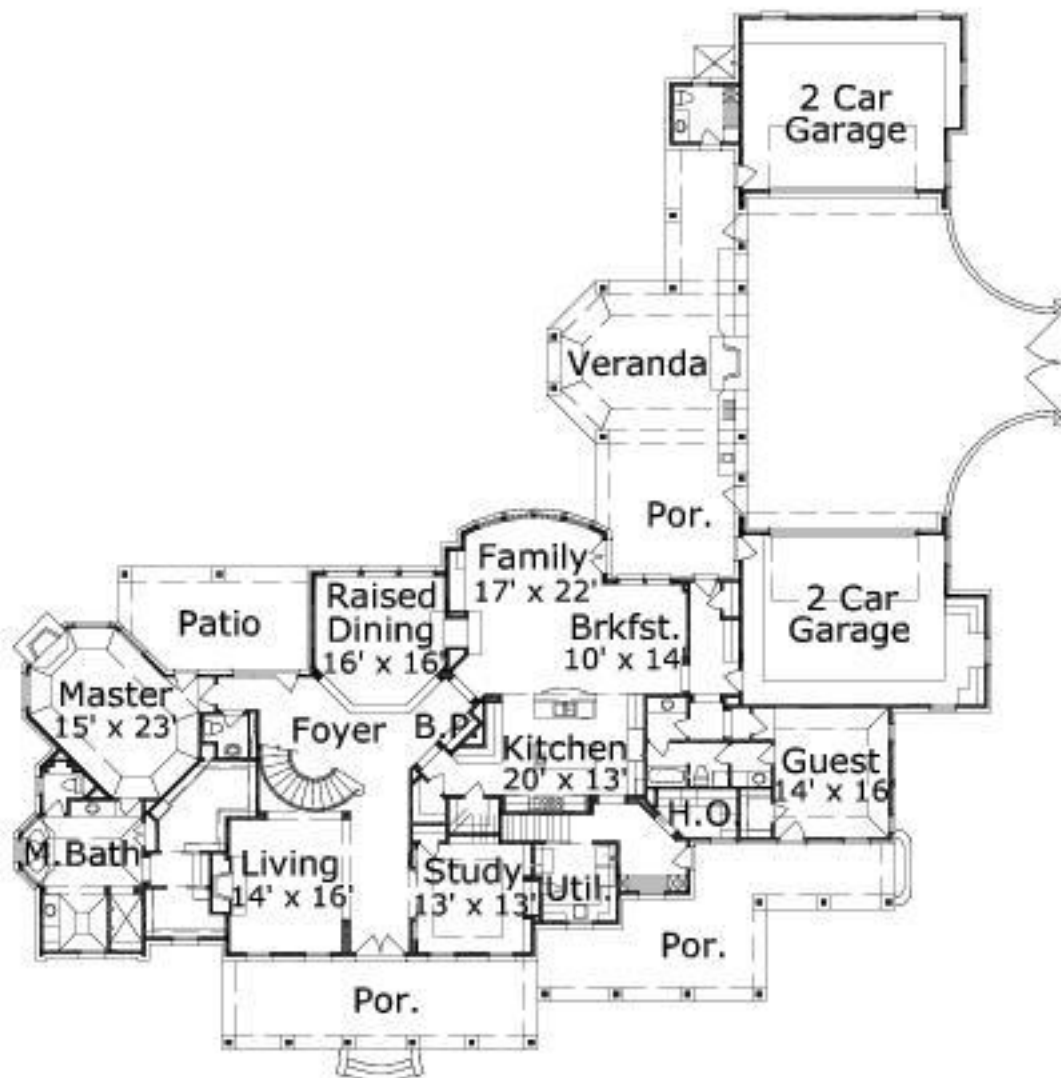

Leonardo 5690: Floor 2

