

## Alpine Pass 2471: Details

<b>Style</b>	Tuscan
<b>Exterior Materials</b>	Brick & Cultured Stone
<b>Bedrooms</b>	4
<b>Bathrooms</b>	4 / 1
<b>Total Living Sq Ft</b>	2,471
<b>Total Covered Sq Ft</b>	4,026
<b>Dimensions (w x d x h)</b>	87'4" x 45'0" x 29'8"

**AS LOW AS \$250**  
**FULLY CUSTOMIZABLE &**  
**PROFESSIONALLY DESIGNED**

	First Floor	Other Floors	Other Features
<b>Square Footage</b>	2,471	221	Bonus Room
<b>Bedrooms</b>	4	0	Covered Rear Porch
<b>Ceiling Heights</b>	10'0"	8'0"	Foyer
<b>Master Bedroom</b>	X		Separate Master Closet
<b>Dining Room</b>	X		
<b>Living Room</b>	X		
<b>Family Room</b>	X		
<b>Study</b>	X		
<b>Guest Room</b>	X		

**Garage(s)** Front Load Straight In  
**Stairs** Standard

### Notes

The living area of this plan does not include the optional second floor bonus room with bath, the optional bedroom 4 with bath on the first floor, and the optional bonus room on the first floor. The additional square footage for the second floor bonus room with bath is 410 square feet. The additional square footage for the optional bedroom 4 with bath is 221 square feet. The additional square footage

## Alpine Pass 2471: Front Elevation



## Alpine Pass 2471: Floor 1

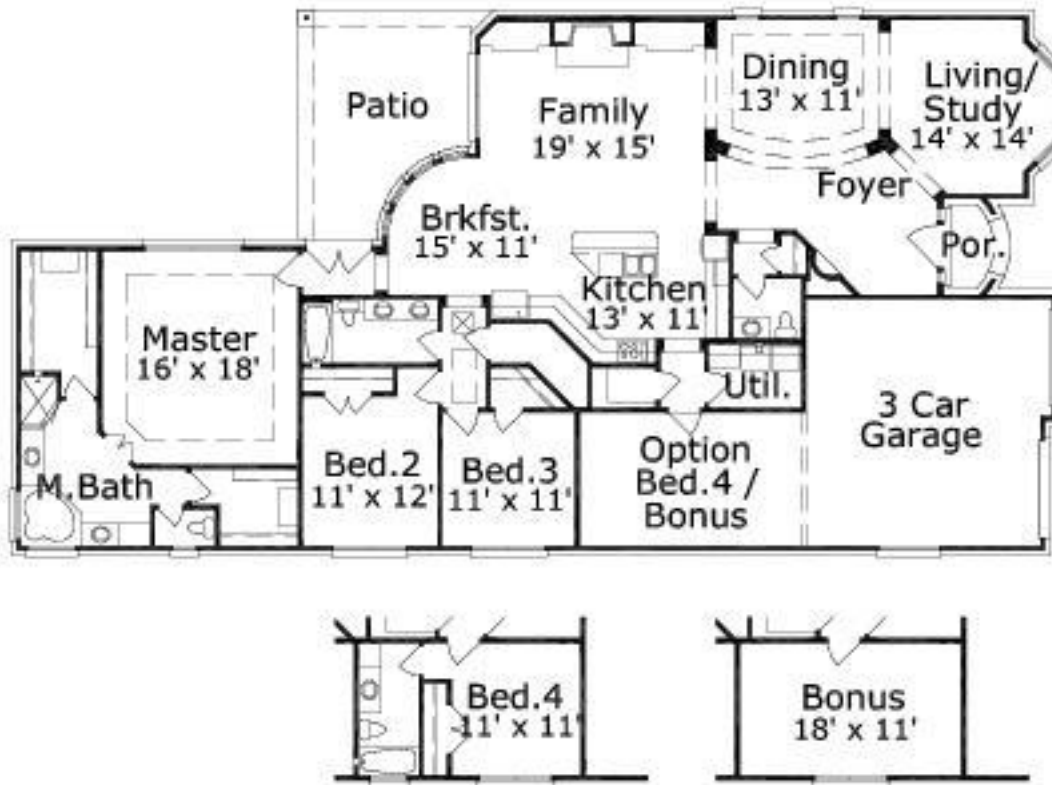

## Alpine Pass 2471: Floor 2

