

Lillington 7189: Details

AS LOW AS \$250
FULLY CUSTOMIZABLE &
PROFESSIONALLY DESIGNED

Style	Mediterranean
Exterior Materials	Stucco
Bedrooms	5
Bathrooms	5 / 1
Total Living Sq Ft	7,189
Total Covered Sq Ft	9,767
Dimensions (w x d x h)	109'8" x 98'2" x 38'9"

	First Floor	Other Floors	Other Features
Square Footage	4,976	2,213	
Bedrooms	2	3	
Ceiling Heights	11'0"	10'0"	
Master Bedroom	X		
Dining Room	X		
Living Room	X		
Family Room	X		
Game Room		X	
Guest Room	X		
Home Theater		X	

Garage(s)	Side Load Swing (Entry Facing)
Stairs	Curved (2 flights)

Notes

The living area of this plan does not include the future area on the second floor. Teh additional square footage for this future area 545 square feet.

Lillington 7189: Front Elevation



Lillington 7189: Floor 1

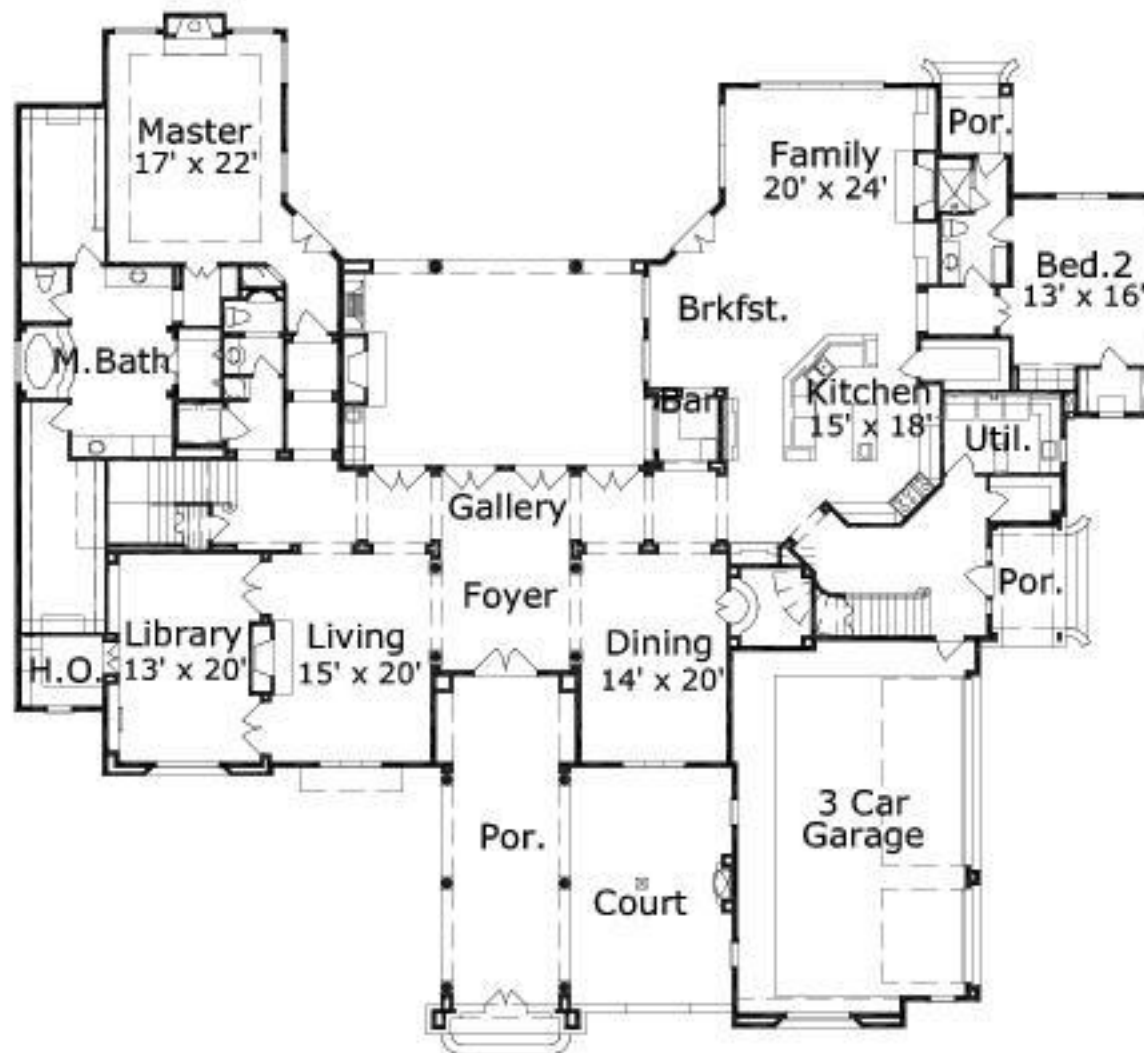

Lillington 7189: Floor 2

