

## leverett 5676: Details

**AS LOW AS \$250**  
**FULLY CUSTOMIZABLE &**  
**PROFESSIONALLY DESIGNED**

|                               |                       |
|-------------------------------|-----------------------|
| <b>Style</b>                  | Mediterranean         |
| <b>Exterior Materials</b>     | Stone & Stucco        |
| <b>Bedrooms</b>               | 5                     |
| <b>Bathrooms</b>              | 5 / 1                 |
| <b>Total Living Sq Ft</b>     | 5,676                 |
| <b>Total Covered Sq Ft</b>    | 7,609                 |
| <b>Dimensions (w x d x h)</b> | 88'6" x 70'2" x 32'6" |

|                        | First Floor | Other Floors | Other Features |
|------------------------|-------------|--------------|----------------|
| <b>Square Footage</b>  | 3,454       | 2,222        |                |
| <b>Bedrooms</b>        | 2           | 3            |                |
| <b>Ceiling Heights</b> | 10'0"       | 9'0"         |                |
| <b>Master Bedroom</b>  | X           |              |                |
| <b>Dining Room</b>     | X           |              |                |
| <b>Living Room</b>     | X           |              |                |
| <b>Family Room</b>     | X           |              |                |
| <b>Game Room</b>       |             | X            |                |
| <b>Study</b>           | X           |              |                |
| <b>Guest Room</b>      |             | X            |                |
| <b>Home Theater</b>    |             | X            |                |

**Garage(s)** Side Load Swing (Entry Facing)  
**Stairs** Curved

## leverett 5676: Front Elevation



## leverett 5676: Floor 1

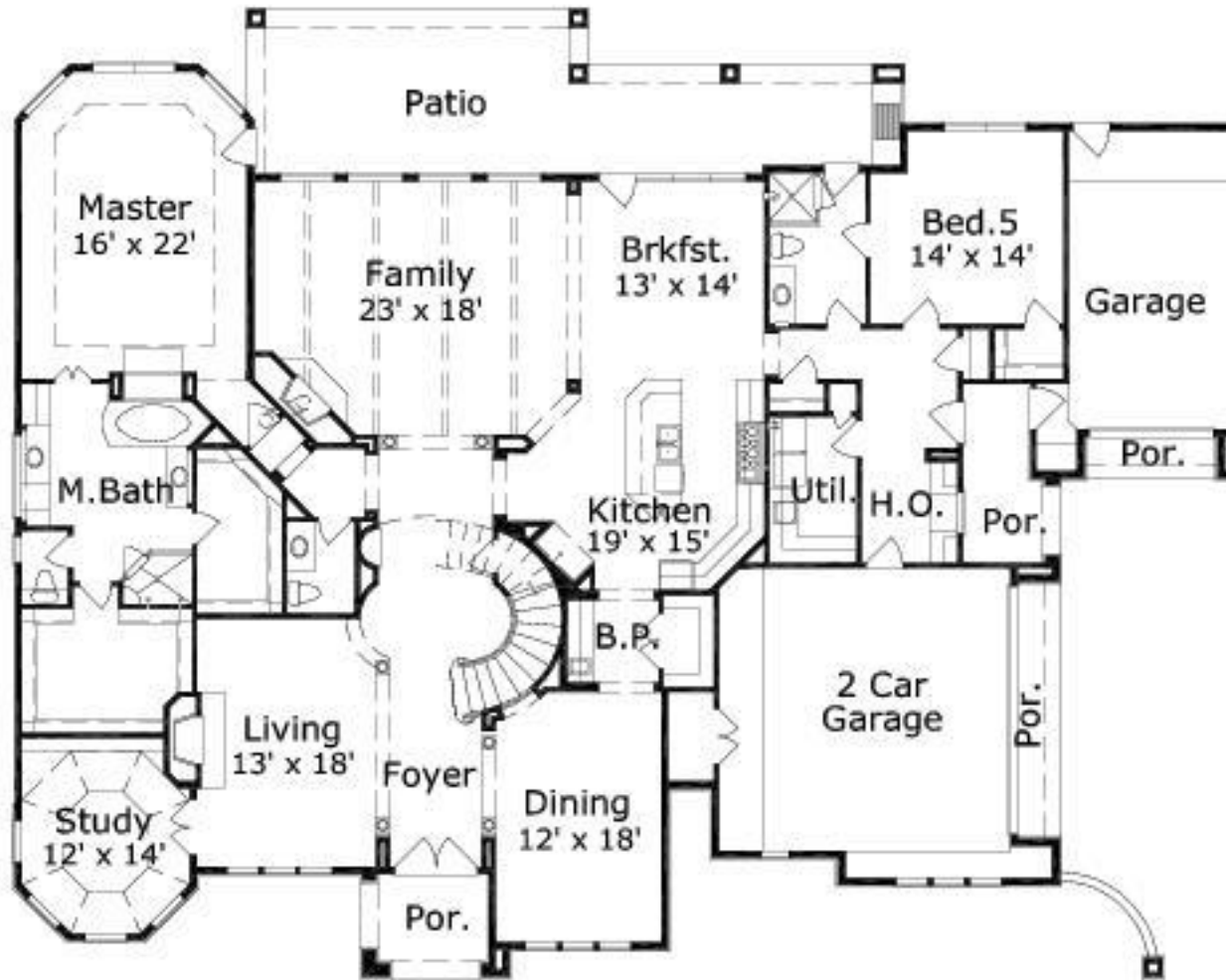

## leverett 5676: Floor 2

