

Bobalink 3252: Details

Style	French
Exterior Materials	Brick, Stone & Stucco
Bedrooms	4
Bathrooms	3 / 1
Total Living Sq Ft	3,252
Total Covered Sq Ft	4,144
Dimensions (w x d x h)	45'0" x 62'6" x 31'2"

AS LOW AS \$250
FULLY CUSTOMIZABLE &
PROFESSIONALLY DESIGNED

	First Floor	Other Floors	Other Features
Square Footage	2,067	1,185	Bonus Room
Bedrooms	1	3	Cov'd. Pavilion
Ceiling Heights	10'0"	9'0"	Cov'd. Rear Porch
Master Bedroom	X		Gallery
Dining Room	X		Int. Balcony
Living Room	X		Outdoor Kitchen
Family Room	X		Playroom
Game Room		X	Rotunda
Study	X		
Guest Room		X	
Garage(s)	Front Load Straight In		
Stairs	Spiral		

Notes

Living square footage does not include the optional 4th bedroom and bath. The additional square footage is 275 square feet.

Bobalink 3252: Front Elevation



Bobalink 3252: Floor 1

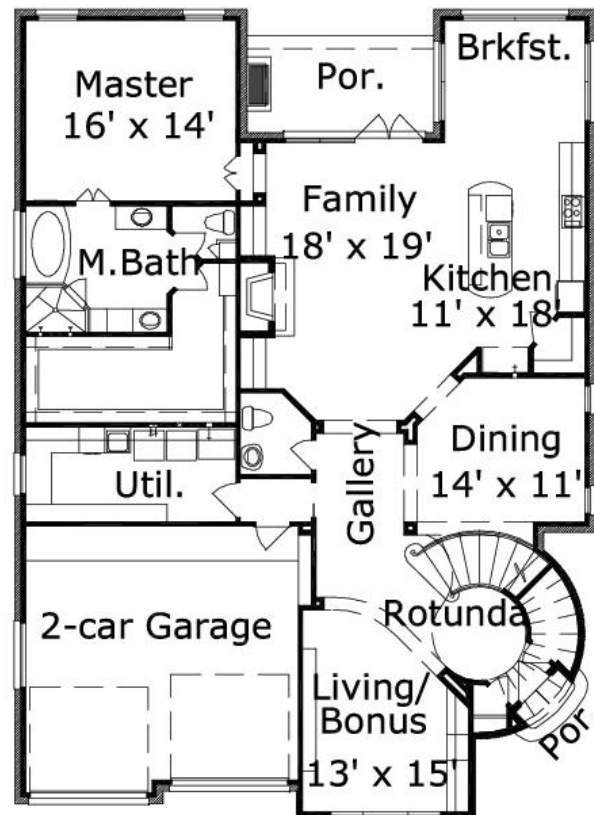

Bobalink 3252: Floor 2

