

## Albemarle 5862: Details

|                        |                         |
|------------------------|-------------------------|
| Style                  | Mediterranean           |
| Exterior Materials     | Stucco                  |
| Bedrooms               | 4                       |
| Bathrooms              | 5 / 1                   |
| Total Living Sq Ft     | 5,862                   |
| Total Covered Sq Ft    | 8,396                   |
| Dimensions (w x d x h) | 118'6" x 85'10" x 33'1" |

**AS LOW AS \$250**  
**FULLY CUSTOMIZABLE &**  
**PROFESSIONALLY DESIGNED**

|                 | First Floor | Other Floors | Other Features    |                 |
|-----------------|-------------|--------------|-------------------|-----------------|
| Square Footage  | 4,205       | 1,657        | Bar               | Outdoor Kitchen |
| Bedrooms        | 1           | 3            | Bonus Room        |                 |
| Ceiling Heights | 10'0"       | 9'0"         | Cov'd. Terrace    |                 |
| Master Bedroom  | X           |              | Foyer             |                 |
| Dining Room     | X           |              | Home Office       |                 |
| Living Room     | X           |              | Int. Balcony      |                 |
| Family Room     | X           |              | Optional Elevator |                 |
| Game Room       |             | X            | Outdoor Fireplace |                 |
| Study           | X           |              |                   |                 |
| Guest Room      |             | X            |                   |                 |

Garage(s) Front Load Swing (Side Facing)

Stairs Curved (2 flights)

### Notes

The future room is not included in the Living square footage. The additional square footage is 558 Square feet.

## Albemarle 5862: Front Elevation



Albemarle 5862: Floor 1

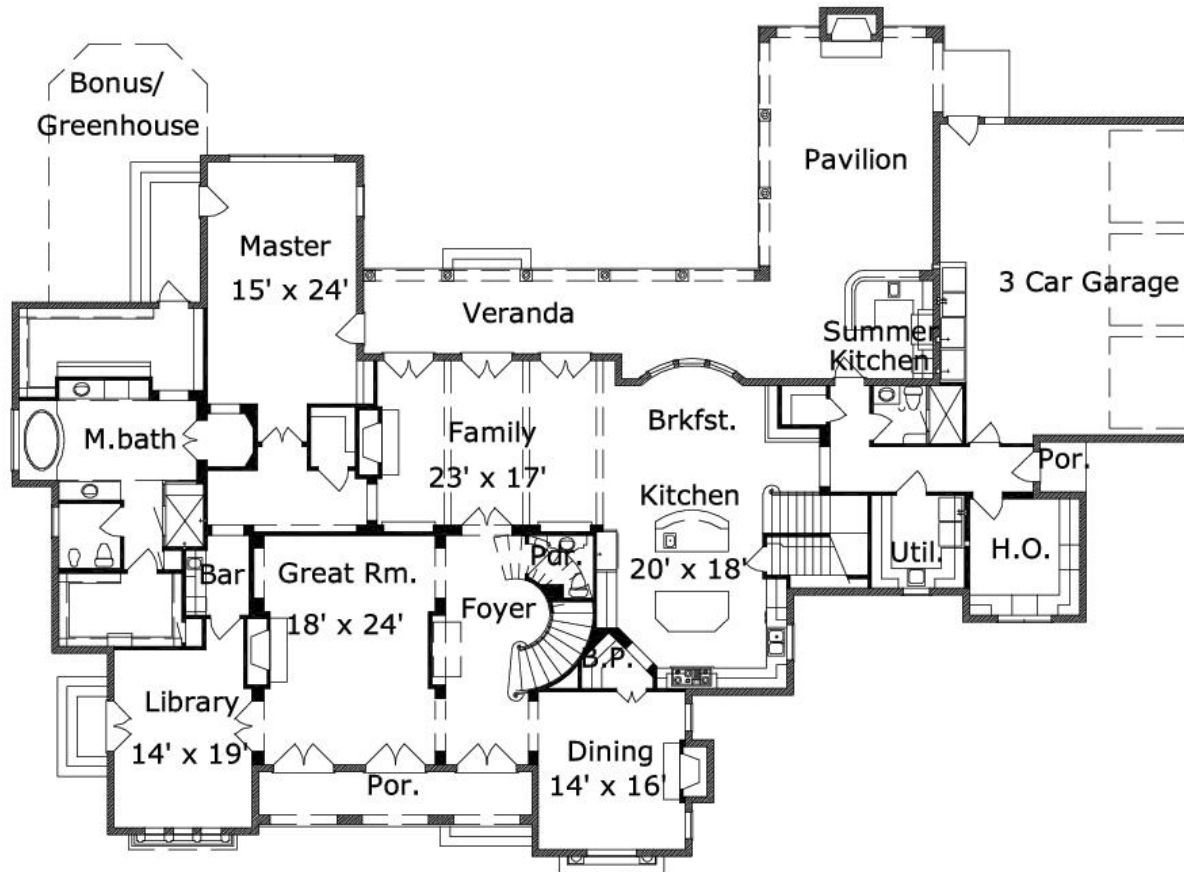

## Albemarle 5862: Floor 2

