

## Childs 2829: Details

Style	Tuscan
Exterior Materials	Stone & Stucco
Bedrooms	4
Bathrooms	3 / 1
Total Living Sq Ft	2,829
Total Covered Sq Ft	3,930
Dimensions (w x d x h)	41'6" x 66'0" x 32'7"

**AS LOW AS \$250**  
**FULLY CUSTOMIZABLE &**  
**PROFESSIONALLY DESIGNED**

	First Floor	Other Floors	Other Features
Square Footage	1,992	837	Foyer
Bedrooms	1	3	Lanai
Ceiling Heights	10'0"	9'0"	
Master Bedroom	X		
Dining Room	X		
Living Room	X		
Family Room	X		
Game Room		X	
Study	X		
Guest Room		X	
Home Theater		X	
Garage(s)	Front Load Straight In		
Stairs	Standard		

### Notes

The optional theatre is not included in the living square footage. The additional square footage for the theatre is 379 square feet.



## Childs 2829: Front Elevation



Childs 2829: Floor 1

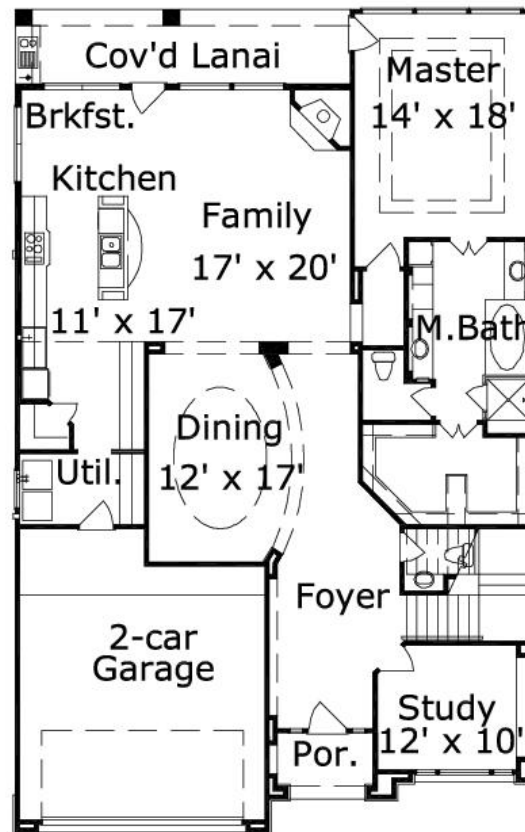

Childs 2829: Floor 2

