

## The Clements 2951.3: Details

<b>Style</b>	Traditional
<b>Exterior Materials</b>	Brick & Cultured Stone
<b>Bedrooms</b>	4
<b>Bathrooms</b>	2 / 1
<b>Total Living Sq Ft</b>	2,951
<b>Total Covered Sq Ft</b>	3,790
<b>Dimensions (w x d x h)</b>	53'6" x 72'8" x 30'10"

**AS LOW AS \$250**  
**FULLY CUSTOMIZABLE &**  
**PROFESSIONALLY DESIGNED**

	First Floor	Other Floors	Other Features
<b>Square Footage</b>	2,080	871	Bonus Room
<b>Bedrooms</b>	1	3	Computer Alcove
<b>Ceiling Heights</b>	10'0"	9'0"	Covered Rear Porch
<b>Master Bedroom</b>	X		Portico
<b>Dining Room</b>	X		Sunroom
<b>Living Room</b>	X		Theater/Media
<b>Family Room</b>	X		
<b>Game Room</b>		X	
<b>Study</b>	X		
<b>Guest Room</b>		X	
<b>Home Theater</b>		X	

<b>Garage(s)</b>	Front Load Straight In
<b>Stairs</b>	Standard

## The Clements 2951.3: Front Elevation



## The Clements 2951.3: Floor 1

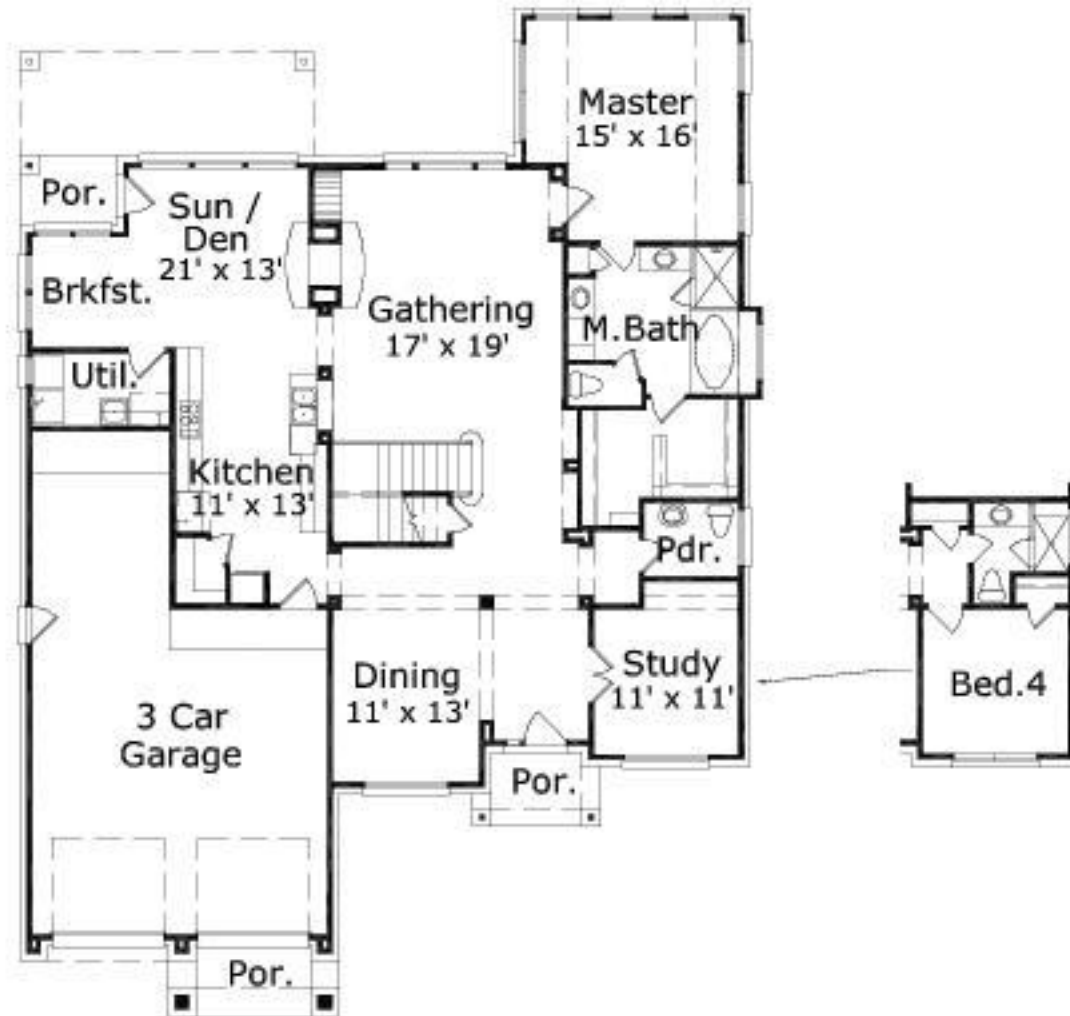

## The Clements 2951.3: Floor 2

