

## Arbutus 4355 : Details

**AS LOW AS \$250**  
**FULLY CUSTOMIZABLE &**  
**PROFESSIONALLY DESIGNED**

<b>Style</b>	Transitional
<b>Exterior Material</b>	Brick & Siding
<b>Bedrooms</b>	5
<b>Bathrooms</b>	5 / 1
<b>Total Living Sq Ft</b>	4,355
<b>Total Covered Sq Ft</b>	5,120
<b>Dimensions (w x d x h)</b>	59' 0" x 66' 8" x 35' 6"

	First Floor	Other Floors	Other Features	
<b>Square Footage</b>	2,254	2,101	Bar	Cov'd. Pavilion
<b>Master Bedroom</b>	X		Exercise Room	Foyer
<b>Dining Room</b>	X		Mud Room	
<b>Living Room</b>	X			
<b>Family Room</b>	X			
<b>Game Room</b>		X		
<b>Study</b>	X			
<b>Guest Room</b>		X		

**Garage(s)** 3 car, Front Load, Straight In  
**Stairs** Standard

## Arbutus 4355 : Front Elevation



## Arbutus 4355 : Floor 1

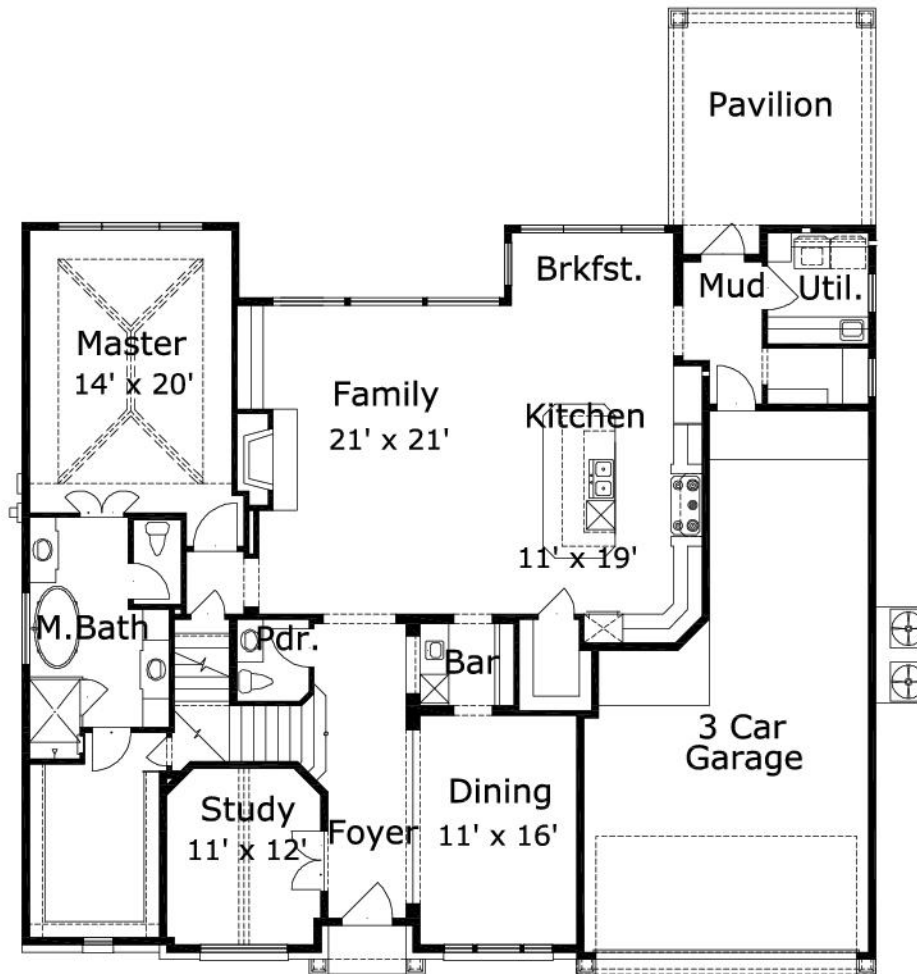

## Arbutus 4355 : Floor 2

